







© Copyright
This drawing and any design herein is the copyright of the
Consultants and must not be reproduced without their written
consent.

All drawings remain the property of the Consultants.

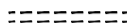
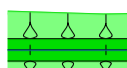
LEGEND

-  PROPOSED FLOOD WALL
-  PROPOSED LOW LEVEL FLOOD WALL
-  EXISTING WALL
-  PROPOSED EMBANKMENT
-  EXISTING BUILDING
-  EXISTING GROUND LEVEL PROPERTY SIDE
-  EXISTING GROUND LEVEL RIVER SIDE
-  PROPOSED DEMOUNTABLE BARRIER

GENERAL NOTES:

1. GROUND LEVELS INDICATED ARE INDICATIVE AS OBTAINED FROM TOPOGRAPHICAL SURVEY.
2. GROUND LEVELS TO BE REINSTATED TO EXISTING LEVELS WHERE FEASIBLE
3. PRELIMINARY LEVELS INDICATED ON DRAWINGS. FINAL TOP-OF-WALL LEVELS TO BE CONFIRMED AT DETAILED DESIGN STAGE
4. PRELIMINARY DETAILS INDICATED ON DRAWINGS. FINAL FLOOD DEFENCE AND CONSTRUCTION DETAILS TO BE CONFIRMED AT DETAILED DESIGN STAGE

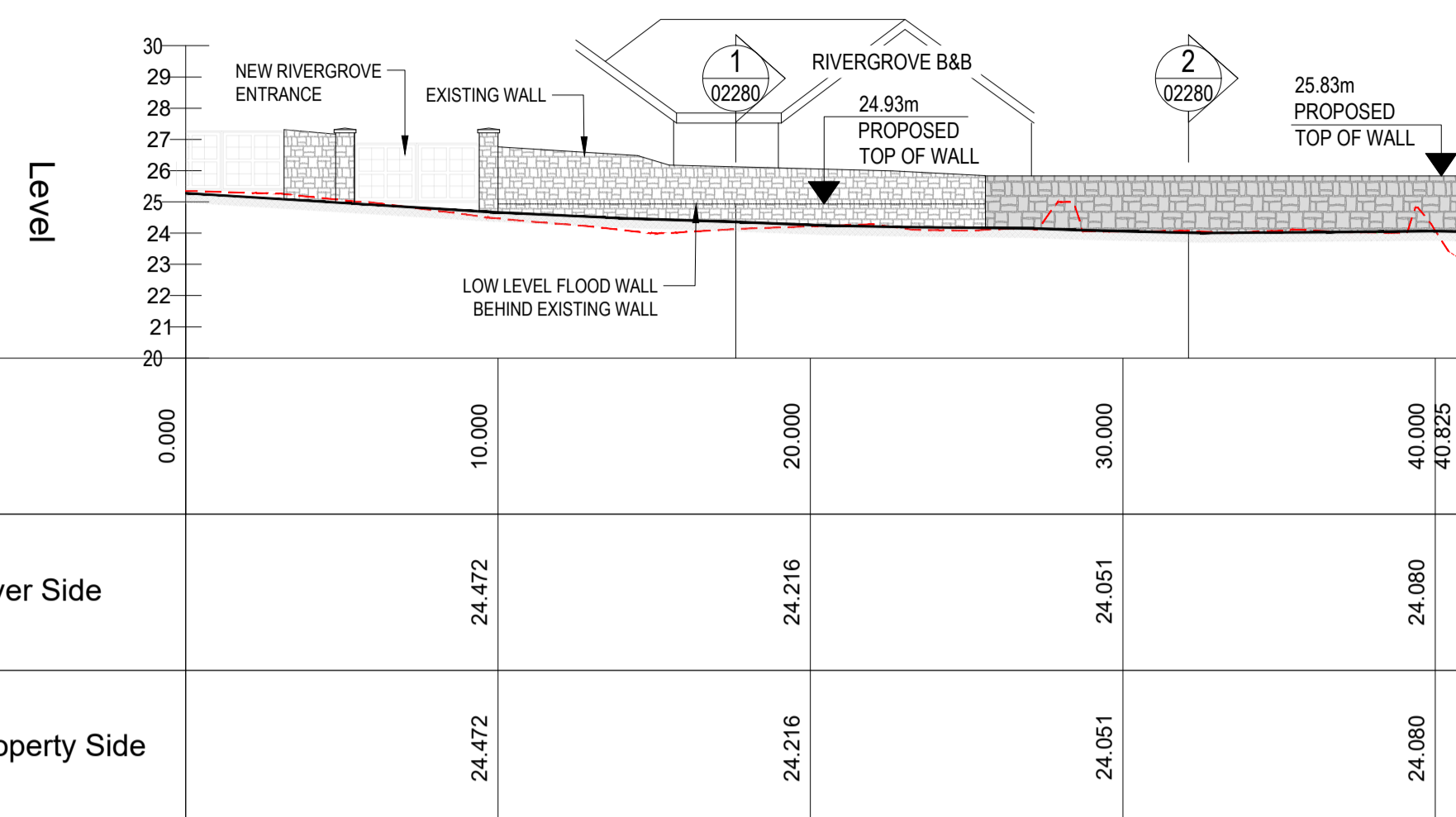

| Chainage | 0.000 | 10.000 | 20.000 | 30.000 | 40.000 | 40.825 |
|---------------------------------|-------|--------|--------|--------|--------|--------|
| Existing Levels - River Side | | 24.472 | 24.216 | 24.051 | 24.080 | |
| Existing Levels - Property Side | | 24.472 | 24.216 | 24.051 | 24.080 | |

WALL 1A - LONGSECTION
SCALE: H 1:200, V 1:200. DATUM: 20.000

WALL 1A
LONGSECTION
SCALE H 1:200, V 1:200

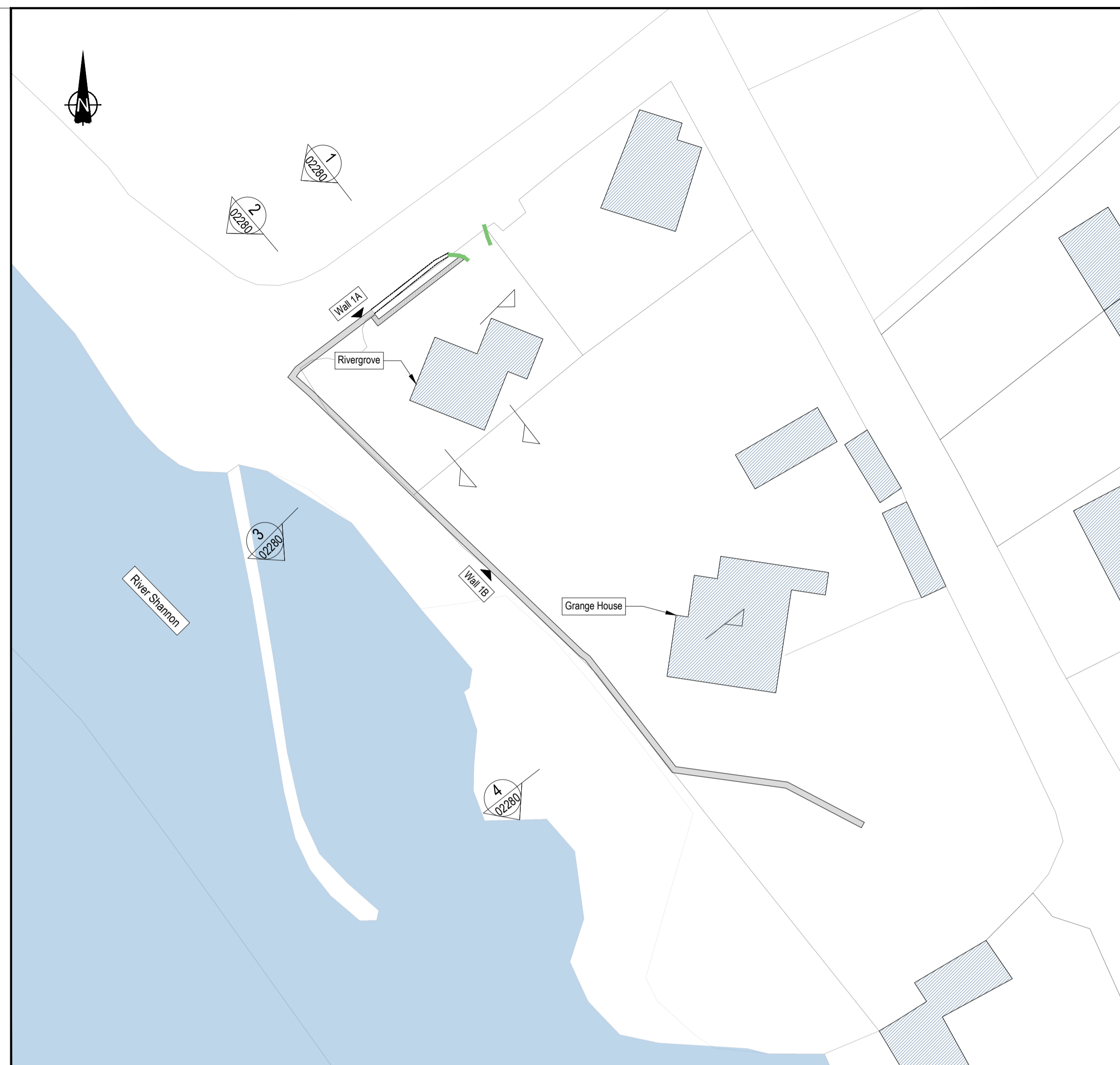

LOCATION PLAN
SCALE 1:500

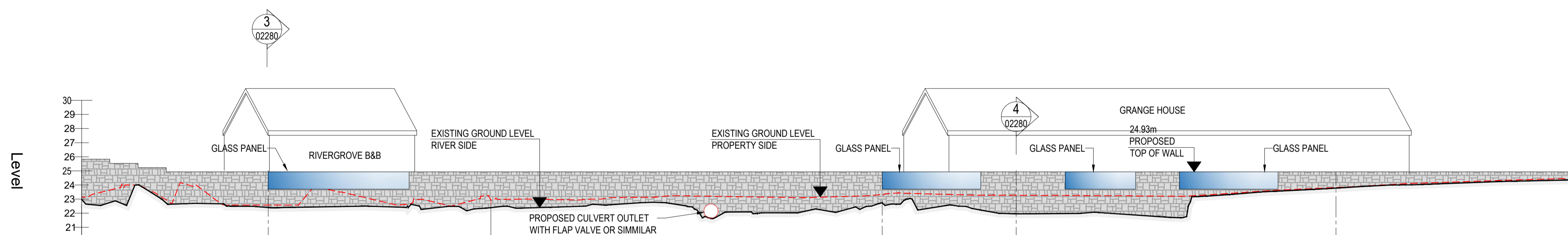

| Chainage | 0.000 | 10.000 | 20.000 | 30.000 | 40.000 | 50.000 | 60.000 | 70.000 | 80.000 | 90.000 | 100.000 | 106.623 |
|---------------------------------|-------|--------|--------|--------|--------|--------|--------|--------|--------|--------|---------|---------|
| Existing Levels - River Side | | 22.666 | 22.466 | 22.489 | 22.763 | 22.024 | 22.325 | 21.977 | 23.219 | 23.834 | 24.217 | |
| Existing Levels - Property Side | | 22.612 | 23.137 | 22.978 | 23.124 | 23.119 | 23.373 | 23.253 | 23.303 | 23.868 | 24.297 | |

WALL 1B - LONGSECTION
SCALE: H 1:200, V 1:200. DATUM: 20.000

WALL 1B
LONGSECTION
SCALE H 1:200, V 1:200

| Rev. | Suit. | Description | Drawn | Ch'kd | Date |
|------|-------|---------------------|-------|-------|------------|
| P01 | S2 | PUBLIC CONSULTATION | DG | WS | 30/08/2023 |

Client



OPW Óifig na nOibreacha Poiblí
Office of Public Works



Comhairle Cathrach
& Contae Luimnigh
Limerick City
& County Council

Clients Representative:



J. B. Barry and Partners Limited Consulting Engineers
Classon House, Dundrum Business Park, Dundrum Road, Dublin 14
www.jbbarry.ie

JBA Consulting Engineers and Scientists Limited
24 Grove Island, Corbally, Limerick
www.jbaconsulting.ie

Project
**CASTLECONNELL
FLOOD RELIEF SCHEME**

Drawing Title
**RIVERGROVE B&B & CORSCADDEN HOUSE
ELEVATIONS & LONGSECTION**

| | | | |
|------------------------|----------------------------|----------------|------------|
| Drawn by : | DG | Date : | 30/08/2023 |
| Checked by : | WS | Date : | 30/08/2023 |
| Approved by : | RK | Date : | 30/08/2023 |
| Internal Project REF : | JBB: 19104 | JBA: 2019a0927 | |
| Scales : | 1:250 @ A1, 1:50 @ A1 | | |
| Stage : | PUBLIC CONSULTATION | | |
| Drawing No.: | 19104-JBB-XX-XX-DR-C-02270 | Revision | S2 |
| | | | |